

## PACKAGE CONTENTS

## URBAN STEEL



Mirror  
x1



Mounting Bracket  
x1

## HARDWARE CONTENTS



Mounting Screw  
x3



Plastic Anchor  
x3



Bubble Level  
x1

## SAFETY INFORMATION

Please read and understand this entire installation instruction.

### WARNING

Safely discard all packing material. Keep small parts away from children. Safety glasses are required during installation.

### CAUTION

Exercise caution when drilling holes into the wall to avoid electrical wiring. If an electrical wire is found, stop the installation and call a professional electrician.

### PREPARATION

Before beginning installation of the product, make sure all parts are present. Compare parts with package contents list and hardware contents list. If any part is missing or damaged, do not attempt to assemble or install the product.

## ASSEMBLY INSTRUCTIONS

1. With the assistance of another, hold mirror (A) in the desired location and lightly mark with a pencil (not included) the wall at the top center edge of the mirror (A)

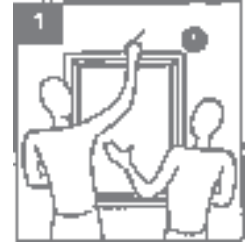

2. Using a ruler or measuring tape (neither included), measure 3 inches down from the initial mark and place a second mark.

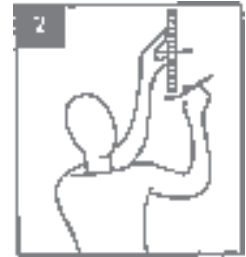

3. Align the bottom of the mounting bracket (B) to the second mark, using bubble level (CC) to make sure the mounting bracket (B) is level. Mark the three screw holes onto the wall.



4. Drill 3/16 in pilot holes at marked screw-hole locations.  
If no stud is present, install plastic anchors (BB) into holes.

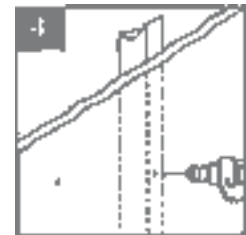

5. Attach mounting bracket (B) to the wall with mounting screws (AA).  
Use bubble level (CC) again to ensure mounting bracket (B) is level.



6. Carefully hang a mirror (A) onto mounting bracket (B).

